



mobility made safe and easy



Overview  
Access Control  
High Security  
ICT  
Emotion

# COMPLEMENTS



# COMPLEMENTS

HARMONISING LIVING SPACES







The Urbaco COMPLEMENTS range of solutions combine benchmark designs in the shape and spirit of the here and now.

Bollards, posts, barriers... a broad range of solutions to protect the freedom of those who have space to share or to complement a controlled access solution guaranteeing the harmonisation of a pedestrian zone or living space.

The COMPLEMENTS range is also an energy distribution system for market places, sale-grounds and spaces where people come and go, needing a hook-up to water, electricity, telephone connections and so on. Available in fixed and retractable versions, they effortlessly fit into the urban landscape without detracting from it in any way.

- Fixed Bollards and Posts

Harmonising  
and marking out living spaces





## Fixed Bollards

Fixed bollards are used in public and private spaces to mark out traffic areas and parking zones or simply to protect spaces vehicles are not permitted to enter.



Fully compliant with  
French decree PMR  
Focus page 19



### CHATEAUNEUF

Material : Cast iron  
Diameter (mm) : 120 - 200 - 250  
Height (mm) : 500 - 750

Material : Steel + Cast iron  
Diameter (mm) : 120  
Height (mm) : 500 - 550 - 750 - 950 - 1200  
Top : Flat or rounded (except diameter 500 & 550)



### CYLINDER

Material : Cast iron  
Diameter (mm) : 120 - 200 - 250  
Height (mm) : 500 - 750

Material : Steel  
Diameter (mm) : 120  
Height (mm) : 500 - 750 - 950 - 1200



### ACROPOLE

Material : Cast iron  
Diameter (mm) : 120 - 200 - 250  
Height (mm) : 500 - 750





Cartier

BOULEVARD

JUMEIRAH EMIRATES TOWERS

## Our Classics

The particularly original and attractive shape of the Cabestan made it a best-seller. Its design, available in several heights, is particularly suited to and appreciated in urban quays, ports, locks and the banks of rivers, canals and lakes in general.

The Arlésienne is the architects' favourite and for French buildings on account of its timeless lines. The history of the Arlésienne bollard has already been writ large in a broad range of prestige sites.



**Fully compliant with  
French decree PMR**  
Focus page 19



### CABESTAN

Material : Cast iron  
Diameter (mm) : 250  
Height (mm) : 310 - 380 - 570



### ARLÉSIENNE

Material : Cast iron  
Dimensions (mm) :  
ø175 x 290  
ø180 x 600  
ø240 x 700  
ø240 x 900 (on demand : min. quantities and specific delays)





# Posts

Classic, elegant, timeless or modern, Urbaco posts are the embodiment of restraint, refinement and discretion, all the better to fit into a wide variety of sites, no matter what the architectural or urban landscape requirements may be.

Their height makes them easily visible to pedestrians and their small footprint reduces the loss of space reserved for pedestrians. What is more, city managers appreciate them using them on their narrow streets and footways.



**Fully compliant with  
French decree PMR**  
Focus page 19



## CHAMPS ÉLYSÉES

Material : Steel  
Diameter (mm) : 60  
Height (mm) : 900 - 1200



## ROND A BOULE

Material : Steel + Cast iron  
Diameter (mm) : 76  
Height (mm) : 900 - 1200



## MISTRAL

Material : Steel  
Diameter (mm) : 76  
Height (mm) : 900 - 1200  
Top : Flat or rounded



## DEMOISELLE

Material : Cast iron  
Diameter (mm) : 90  
Height (mm) : 900





intermarché

7299 TR 84

- Energy Distribution Bollards

Practical,  
Accessible,  
totally safe energy





## Energy Distribution Bollards: Be-NRJ

Wherever there may be a temporary energy requirement, be it for electricity, water or other services, energy distribution bollards are the ideal solution, guaranteeing a totally safe energy supply.

This type of bollard means the end for dangerous or make-shift connections or cables, and of the risks associated with cables strewn over the ground.

### Retractable version

The Urbaco semi-automatic **Be-NRJ** is moved using a key which releases the mechanism. The bollard returns to its fully raised position automatically, where it is locked in place. They provide their users and the general public with a guarantee of total safety.

They can be used in a large number of settings\*: markets, sales, funfairs, exhibitions, concert halls, camp sites, multi-use areas and rooms, sports complexes, recreational areas, technical service areas, laboratories, car parks and hospitality areas. The new generation of service bollards combine functionality with design.



### Removable version

The bollard is removable. It is bolted at the bottom of the casing. It can be removed and the created hole protected by a closing cover for extraordinary situations.

In these kind of events, mains (electrical and water) have to be disconnected by authorized people.

The front door is lockable® to protect goods and people in case of usage from unauthorized operators.

This front door is removable and can be clipped at the back of the bollard® in order to prevent to be damaged while dismantling and transportation.

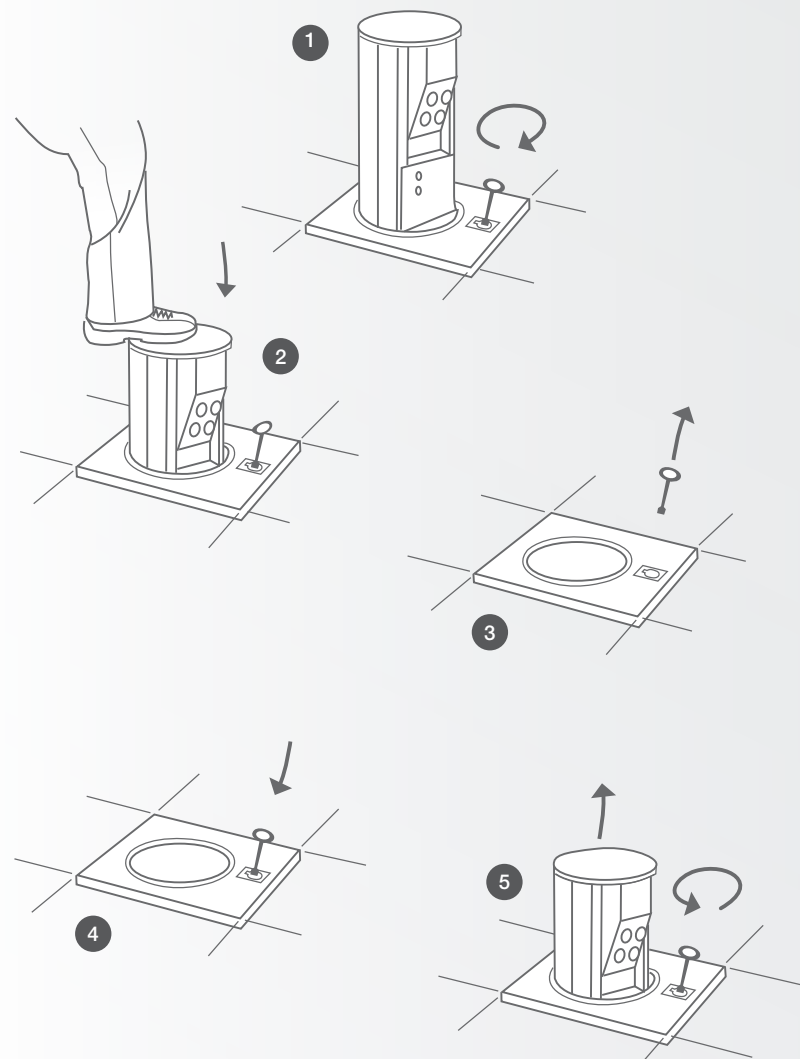

\* The bollards can withstand a 12,5-tonne force (as per EN124-B125 standard), meaning they can be fitted in walkways, pedestrian precincts and comparable areas, parking lots and car parks.



## Surface Coating and Finish

Steel

The bollard gets a rich in zinc primer as standard in order to reinforce its rust-inhibiting performance and improve the polyester finishing paint adherence.

Teardrop finishing plate  
Available in the entire RAL colour range.



RAL3020  
standard



Other RAL  
in option

## Dimensions

Ø320mm  
H800mm

## Energy distribution

Various configurations are available in full electrical distribution, full water distribution or a combination of the two.



### Electricity

2 to 6 sockets (each socket is independently protected with its own overcurrent disconnector)

16A to 125A - single or three phase current



### Water

2 to 6 outlets

Anti-freeze bleeding system

## Retractability

Gas spring are used for easy bollard raising up

Unlocking using the Urbaco E11 Triangle Key (standard)\*

Other locking key shape in option



E11\*



E14



EDL



ESA



EPE

## Option

- Lost casing
- Additional key
- Class II lateral reflective band in black and yellow

## Energy Distribution Bollards: BFDE

### Fixed Version

The fixed energy distribution bollard (French abbreviation, BFDE) is designed for easy-to-make multiple low voltage 16, 32 or 63 amp connections. It is available in single (up to six 16 amp sockets) and double (up to twelve 16 amp socket) versions.

The fixed energy distribution bollard is also available in a mixed (electricity and water) version.

With the fixed energy distribution bollard it becomes possible to provide an electricity and/or water supply that is not only totally safe, but also fits in beautifully with its urban surroundings.

Its solid construction means it can be permanently fitted in public places such as market places, amusement parks, camp sites and so on.





### Surface Coating and Finish

The painted bollard top has a clear-coat finish and this process ensures exceptionally enduring colour even in extreme conditions.  
Available in the entire RAL colour range



RAL7016  
standard



Other RAL  
in option

### Energy Distribution

Various configurations are possible: all electricity, all water, or a combination of the two.



#### Electricity

2 to 12 separate sockets with circuit breaker  
16 to 63A - single phase or 4-wire



#### Water

2 to 4 outlets  
Anti-freeze purging system

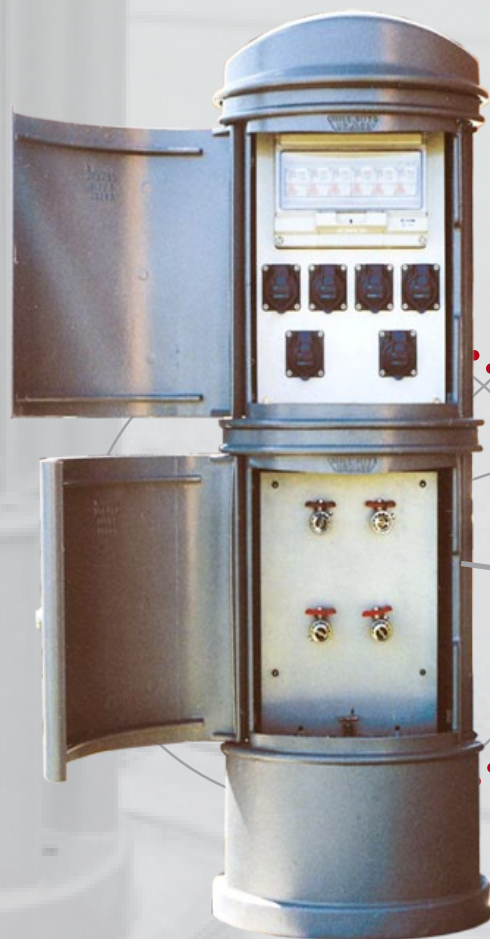

Available in simple version or double version

FOCUS





# PMR Range

Because safety is important for all of us, and particularly for more vulnerable persons, **Urbaco** offers its PMR range, comprising illuminated bollards and posts with audible warnings, contrasting colours and specific sizes to fully comply with **the French decree of 18 september 2012 modifying the decree of 15 january 2007 applying Decree 2006-1658 of 21 December 2006 regarding technical specifications for access on roadways and spaces, enabling Persons with Reduced Mobility** to have the best possible day-to-day travel.

Convinced that enterprise has a major role to play at the heart of civil society and that its role places it at the very centre of urban development and social progress, **Urbaco** is committed to people with disabilities to ensure they have access to urban areas.



mobility made safe and easy

Intellectual property of URBACO - Copying forbidden - Specifications not contractually binding - Changes may be made without prior notice - Most of the models shown are patented - 03/2013  
URBACO S.A. - a limited liability company with a capital of 1.5 M€ - Siret 33944567800032 R.C.S. AVIGNON 1999 B 40305 - VAT FR 06 539 445 67 8w



**Urbaco S.A.**  
457 avenue du Clavier  
84320 Entraigues - FRANCE  
Tél. + 33 (0)490 480 808  
[www.urbaco.com](http://www.urbaco.com) - [urbaco@urbaco.fr](mailto:urbaco@urbaco.fr)



COMPLEMENTS-V2-EN